

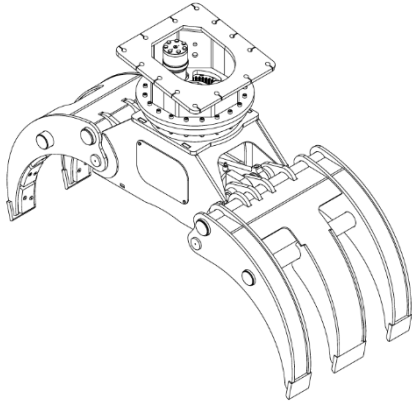

HTLG-HD800



Max load	-kg
Area	0.8m ²
Weight	735 kg

Cylinder	Diameter	Recommend pressure
Pipe 105-90mm	Shaft = 60mm	160 bar

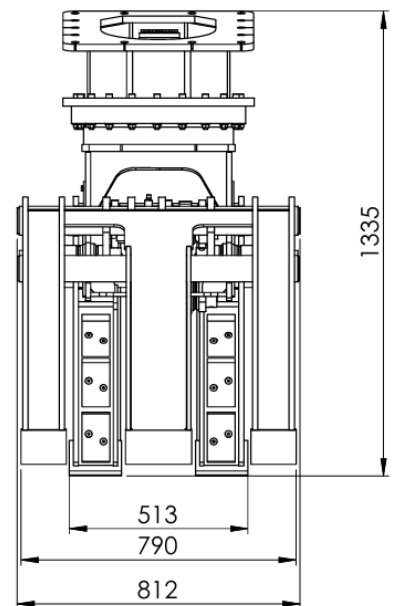
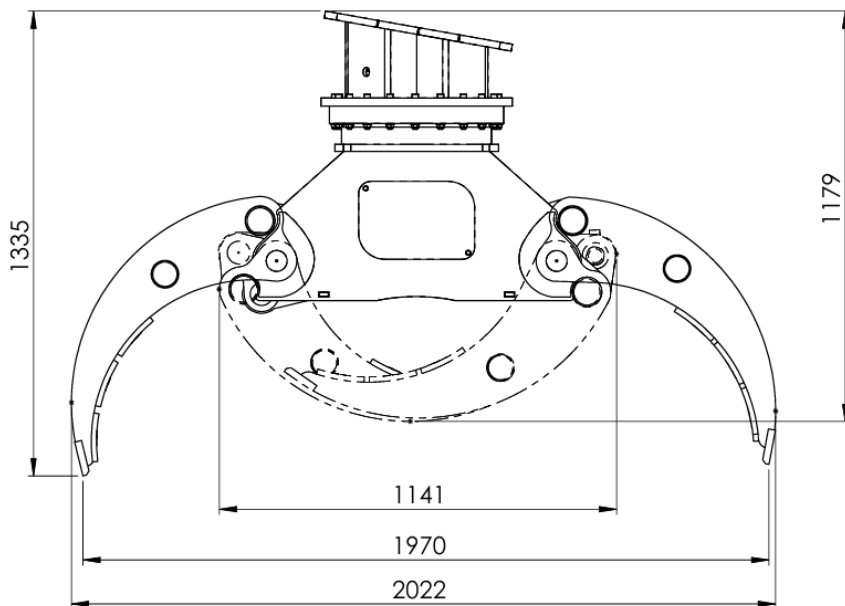

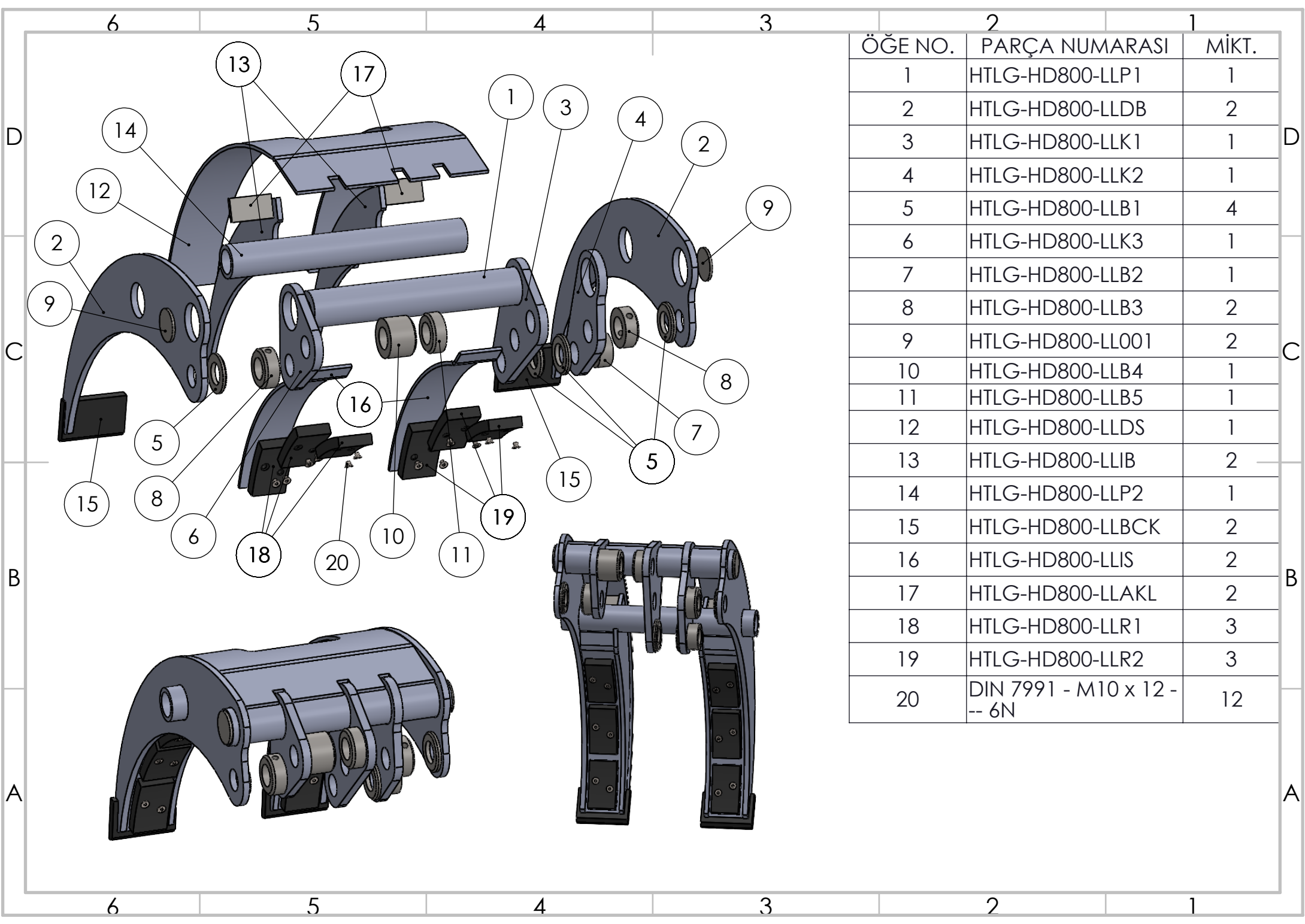

ÖĞE NO.	PARÇA NUMARASI	MİKT.
1	HTLG-HD800-LLP1	1
2	HTLG-HD800-LLDB	2
3	HTLG-HD800-LLK1	1
4	HTLG-HD800-LLK2	1
5	HTLG-HD800-LLB1	4
6	HTLG-HD800-LLK3	1
7	HTLG-HD800-LLB2	1
8	HTLG-HD800-LLB3	2
9	HTLG-HD800-LL001	2
10	HTLG-HD800-LLB4	1
11	HTLG-HD800-LLB5	1
12	HTLG-HD800-LLDS	1
13	HTLG-HD800-LLIB	2
14	HTLG-HD800-LLP2	1
15	HTLG-HD800-LLBCK	2
16	HTLG-HD800-LLIS	2
17	HTLG-HD800-LLAKL	2
18	HTLG-HD800-LLR1	3
19	HTLG-HD800-LLR2	3
20	DIN 7991 - M10 x 12 - -- 6N	12

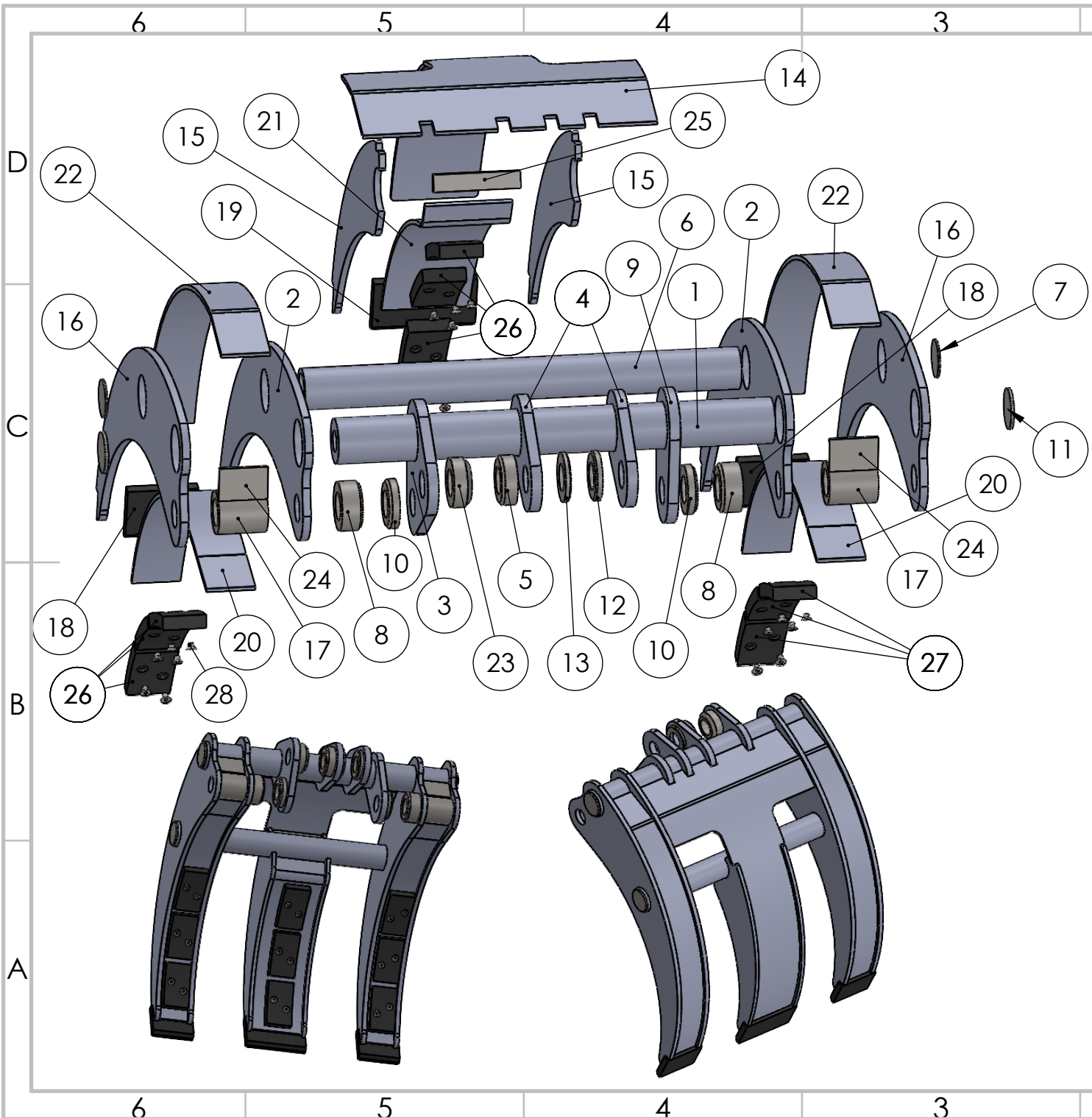

ÖĞE NO.	PARÇA NUMARASI	MİKT.
1	HTLG-HD800-RLP1	1
2	HTLG-HD800-RLDIB	2
3	HTLG-HD800-RLK1	1
4	HTLG-HD800-RLK2	2
5	HTLG-HD800-RLB1	1
6	HTLG-HD800-RLP2	1
7	HTLG-HD800-RL001	2
8	HTLG-HD800-RLB2	2
9	HTLG-HD800-RLK3	1
10	HTLG-HD800-RLB3	2
11	HTLG-HD800-RL002	2
12	HTLG-HD800-RLB4	1
13	HTLG-HD800-RLB5	1
14	HTLG-HD800-RLOBDS	1
15	HTLG-HD800-RLOB	2
16	HTLG-HD800-RLDDB	2
17	HTLG-HD800-RLB6	2
18	HTLG-HD800-RLBCK1	2
19	HTLG-HD800-RLBCK2	1
20	HTLG-HD800-RLDBIS	2
21	HTLG-HD800-RLOBIS	1
22	HTLG-HD800-RLDBDS	2
23	HTLG-HD800-RLB7	1
24	HTLG-HD800-RLBK	2
25	HTLG-HD800-RLOBAL	1
26	HTLG-HD800-RLR1	6
27	HTLG-HD800-RLR2	3
28	DIN 7991 - M10 x 12 -- - 6N	18

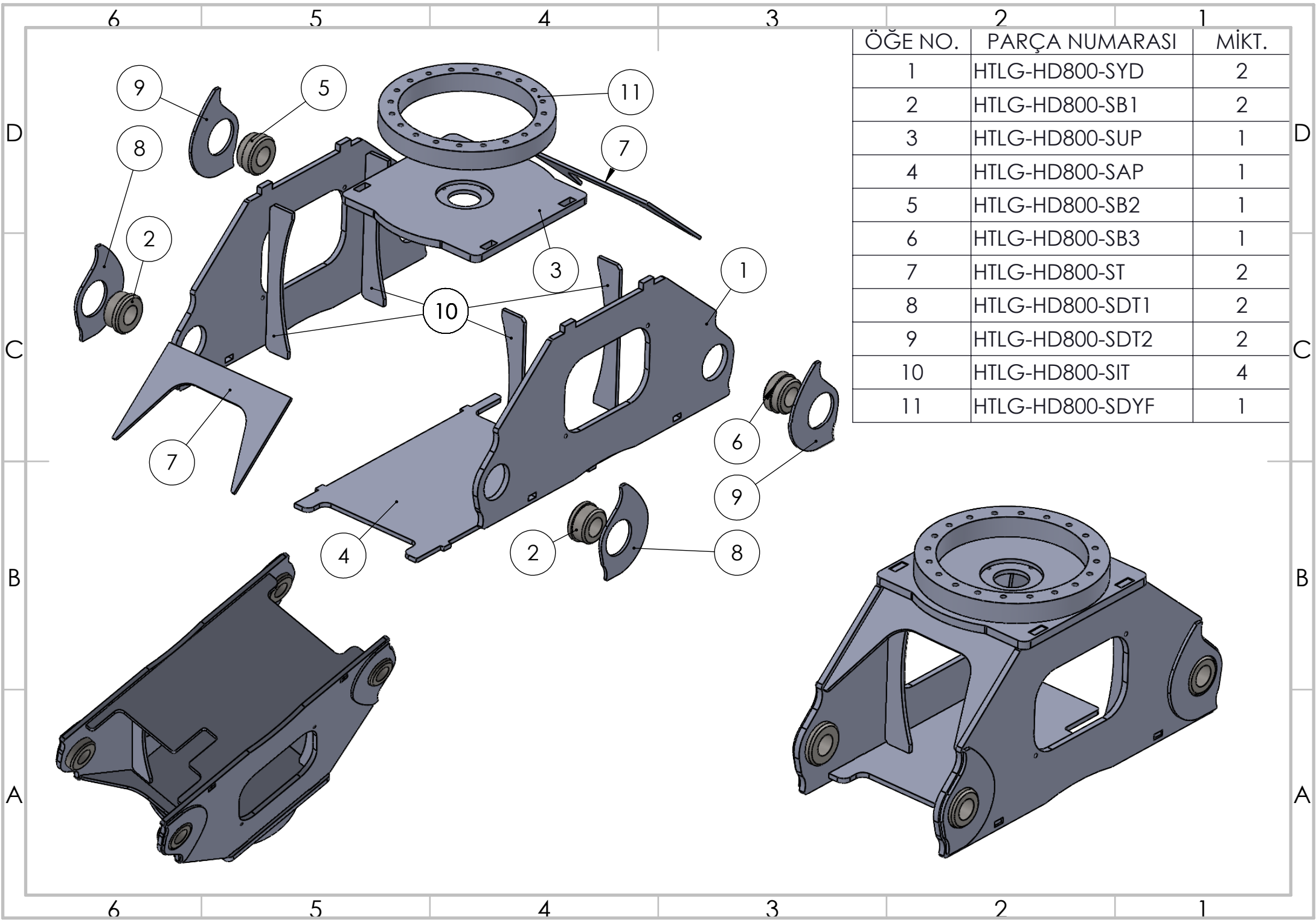

ÖĞE NO.	PARÇA NUMARASI	MİKT.
1	HTLG-HD800-SYD	2
2	HTLG-HD800-SB1	2
3	HTLG-HD800-SUP	1
4	HTLG-HD800-SAP	1
5	HTLG-HD800-SB2	1
6	HTLG-HD800-SB3	1
7	HTLG-HD800-ST	2
8	HTLG-HD800-SDT1	2
9	HTLG-HD800-SDT2	2
10	HTLG-HD800-SIT	4
11	HTLG-HD800-SDYF	1

